

Blind Cap Assembly

PN 60464 / 60464BGES

PN 60464 should be used when mounting on a vessel surface with a knife edge present, i.e., on a manifold or standpipe. PN 60464B should be used when mounting on a flat vessel surface.

60464 on Manifold or Standpipe

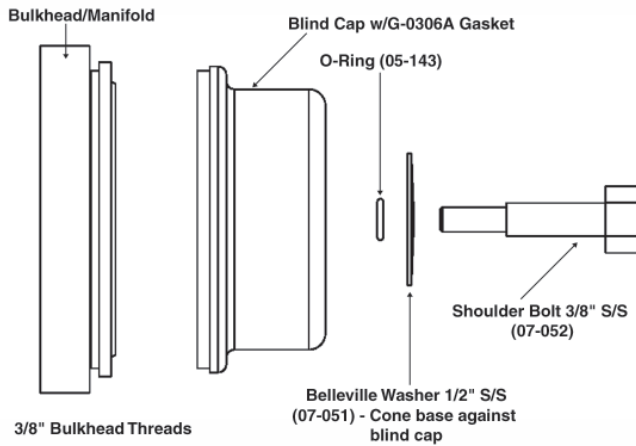

60464B on Flat Sealing Surface

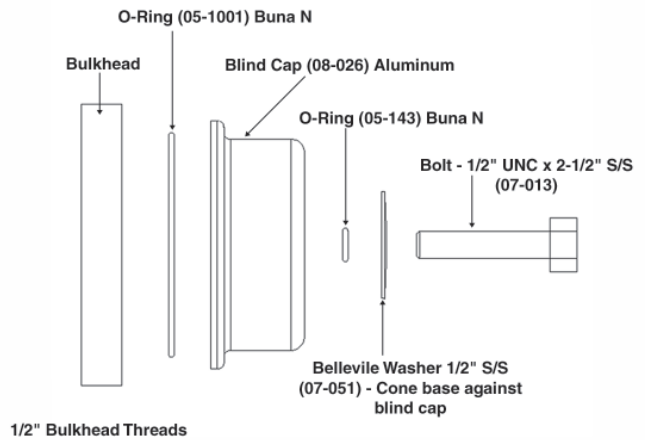
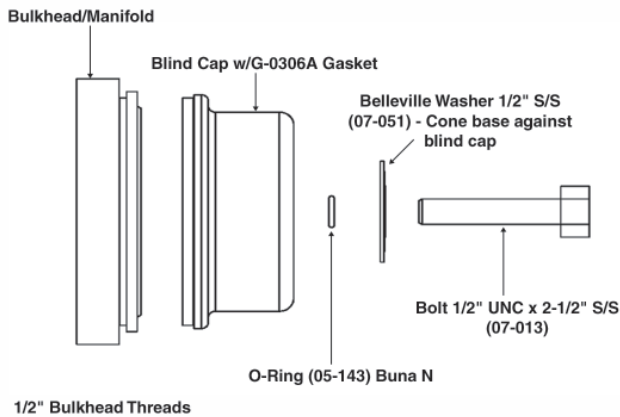
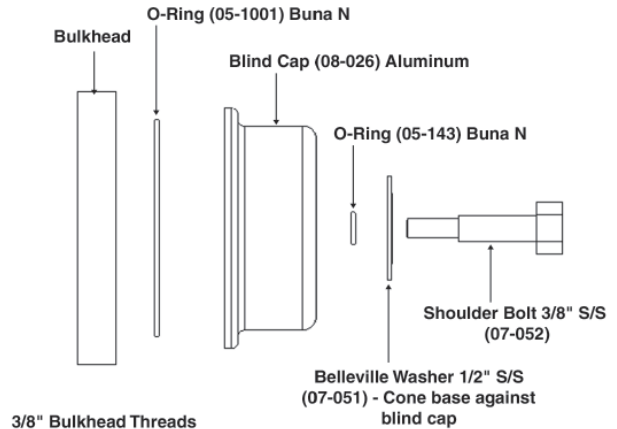

1. 1. Determine bulkhead threads.
2. 2. Verify blind cap assembly for correct sealing surface.
3. 3. Use appropriate bolt and washers for bulkhead threads.
4. 4. Install assembly as shown.
5. 5. Tighten the bolt using a torque wrench to 15 ft-lbs.